

Newton SIGNAGE

Newton Signage Operation Manual

WC32FAFSA | WC43UAFSA | WC55UAFSA | WC65UAFSA

CONTENTS

01	Start Setup
02	Source
03	M-Sign
04	Local Signage
05	Screen Mirroring
06	Fastcast
07	HDMI
08	Settings

01_ Start Setup

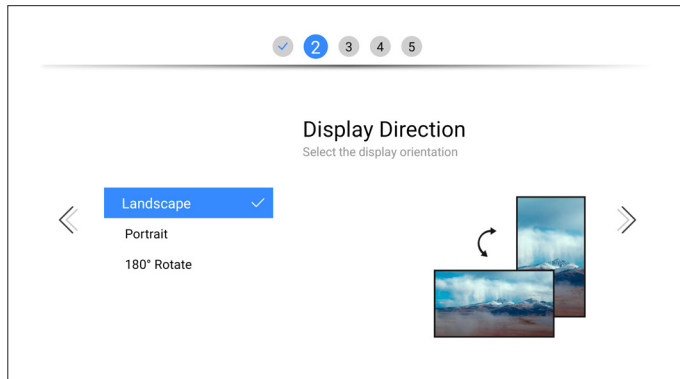
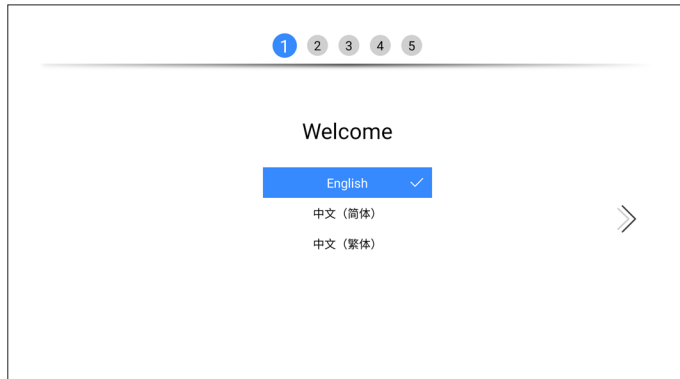

After the first start up, users will be in boot guide, users can initialize the system, set the language, display orientation, network, clock and play mode.

1. Language

Select the language to display

- English / Deutsch / Italiano / Español / 中文(简体) / 中文(繁体) / العربية / 한국어 / Français / Português

2. Select the display orientation

Control the display orientation of the screen

- Landscape / Portrait / 180° Rotate

01_ Start Setup

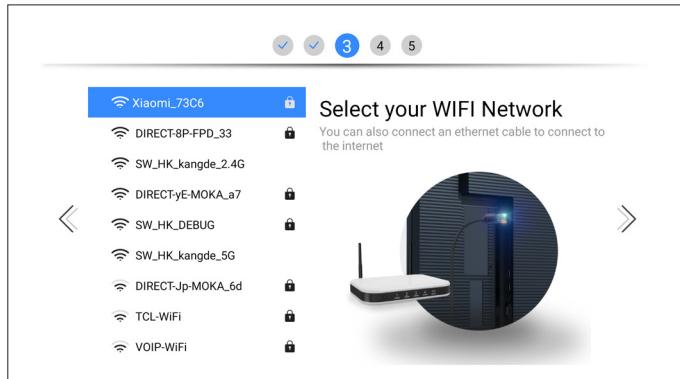

3. Wi-Fi Network

Here you can connect to the wireless network in advance, or skip it. After entering the system, you can connect to the network in the settings menu.

STEPS

Select WiFi → Enter password → Confirm connection

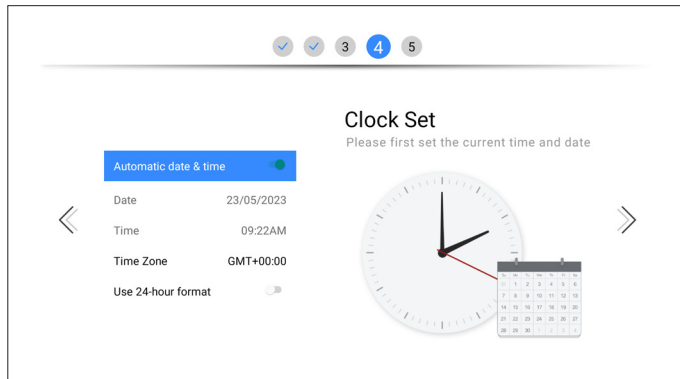

4. Clock

Time can be calibrated automatically or manually

When Automatic date & time is turned off, Date, Time and Time Zone can be set manually; When manually setting Date and Time, it is all set by pressing **OK** on the remote, modifying it by pressing the up and down keys, selecting the next option with the left and right keys, and pressing **OK** after completion; When manually setting the Time Zone, press **OK** to type in, press the up and down keys to modify the options, and press the **OK** key after completion.

- Automatic date & time
- Date
- Time
- Time zone
- Use 24-hour format

01_ Start Setup

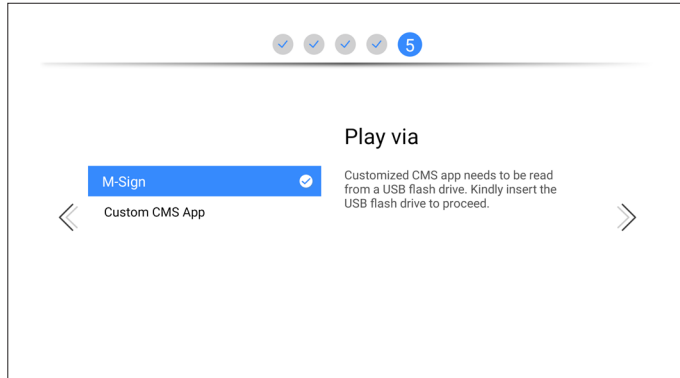

5.Play via

Select the player type that best meets your needs.

Use custom App instead of M-sign. When the device is turned on, the custom App will start.

- M-Sign
- Custom Ap (By selecting this option, you can independently install applications to serve as the main CMS)

02_ Source

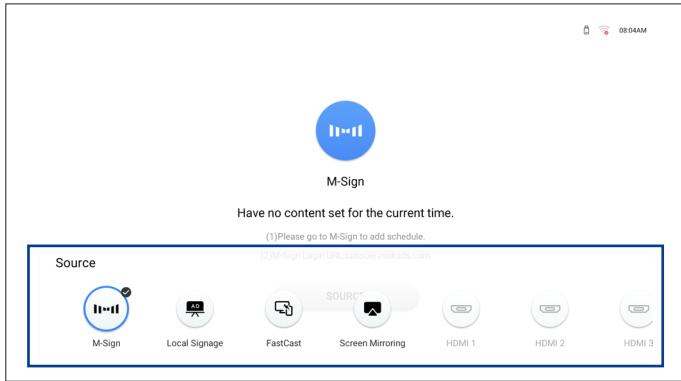

Various signal can be selected through the Source.

You can select the source that you want in the source menu, select it and press **OK** to display the content of the source.

Source included in M-Sign

- **M-Sign** : Send media resources by using M-Sign (Note that this source can also be replaced with other source applications during the setup)
- **Local Signage** : Local digital signage system, insert U disk, select U disk resource to play
- **FastCast** : Connect to the mobile phone network disk, select the media resources of the mobile phone to play
- **Screen Mirroring** : Mirror casting function. This casting function supports screen mirroring on four systems: Windows, Mac, Android, and iPhone.
- **HDMI1 / HDMI2 / HDMI3** : Connect to other devices via HDMI, and display the content directly. When HDMI signal is connected, the icon will be highlighted



How to call out the source :

1. Press the **SOURCE** under each source to call out
2. Press the  in the remote to call out

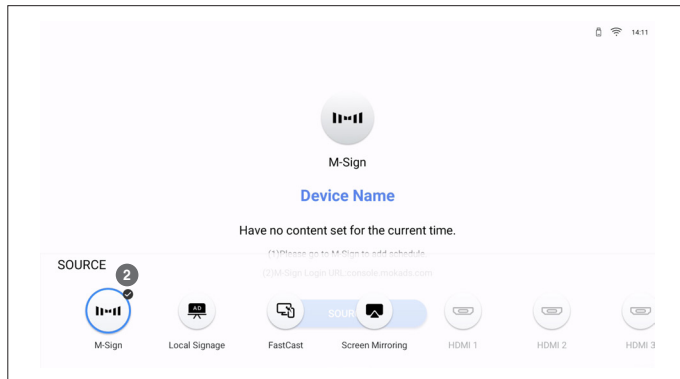
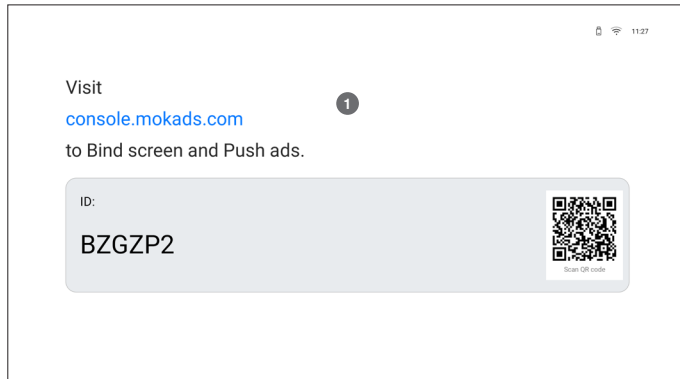
03_ M-Sign





How to use M-Sign :

- **First entry** : Obtain device ID on the Internet - > enter the ID into the digital signage system -> Set playback resources in the signaling system
- **Detailed steps** : Press the remote control  button ,Select M-Sign , Go to the ID display page , After networking, obtain the ID of the system, enter the ID into the digital signage system, you can bind the machine to the signaling system, and then you can set up playback content on the signaling system.
- **Re-entry** : When entering again, if the digital signage system is set to play content, you can directly stay on the M-Sign homepage and wait for the loading to complete playback.

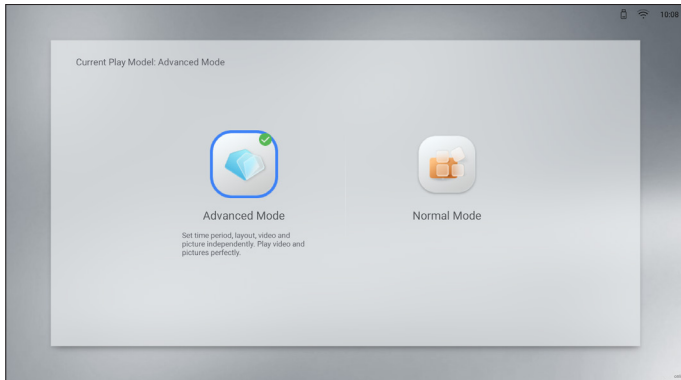
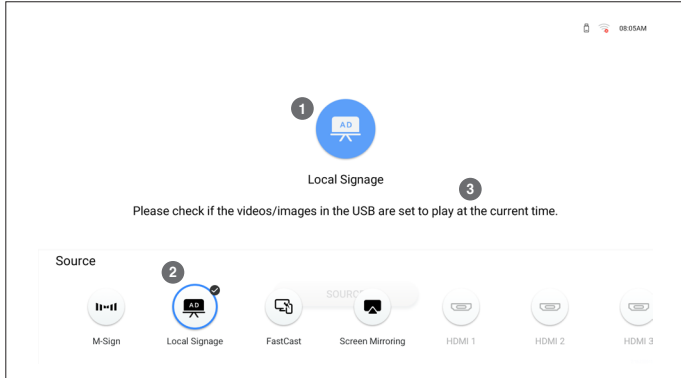
04_ Local Signage

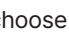

How to enter Local Signage :

1. Press the icon  in Local Signage to enter
2. Press the  in the remote, and choose Local Signage  to enter

Local Signage Homepage Prompt :

- **Contents will be played at 30S** : Prompt when  the U disk is inserted and there are playback resources currently set
- **Please check if the videos/images in the USB are set to play at the current time.**
Prompt when no U disk is inserted, no media resources are in the U disk, and no playback content is set at the current time

Choose the mode of Local Signage :

Local Signage has **Advanced Mode** and **Normal Mode**

- **Advanced Mode** : You can customize the settings to select the resources in the U disk, and you can set the precise playback time; you can set 5 time periods to play different resources
 - Set precise playback times (accurate to the minute), playback layouts, and media resources for each time period
 - Include : Timer, Layout, Videos/Pictures, General
- **Normal Mode** : All U disk resources will be played, and resources cannot be customized
 - Selected by default, insert the U disk, play immediately after loading resources
 - Include : Timer, Layout, General

04_ Local Signage

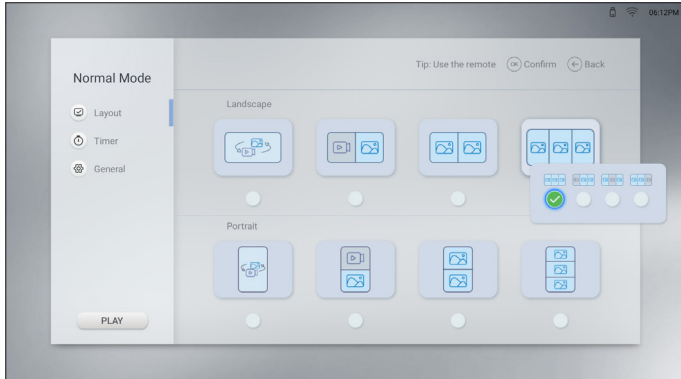

Normal Mode - Layout

"Layout" is to set the layout style of the playback page, including horizontal and vertical, each category is divided into 4 subcategories, with a total of 8 layouts.

- **Landscape** : Display content with horizontal screen
 - Full screen display, first play the video, then play the picture; you can also unicast the video or picture
 - left 1/2 is video, right 1/2 is picture
 - left 1/2 is picture, right 1/2 is picture
 - left 1/3 is picture/video, middle 1/3 is picture/video, right 1/3 is picture/video
- **Portrait** : Display content with vertical screen
 - Full screen display, first play the video, then play the picture; you can also unicast the video or picture
 - up 1/2 is video, down 1/2 is picture
 - up 1/2 is picture, down 1/2 is picture
 - up 1/3 is picture/video, middle 1/3 is picture/video, down 1/3 is picture/video

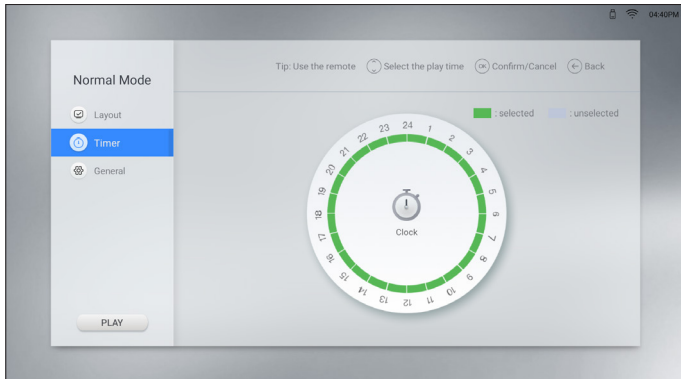

Normal Mode - Timer

"Timer" means time setting, and all are selected by default.

Choose any hour from 0-24 o'clock, the playback page will start during the selected time period.

■ Selected ■ Unselected

Reminder : Left key on the remote is control key in time selection, press up and down keys to select time period, after selection, press right key to return.

04_ Local Signage

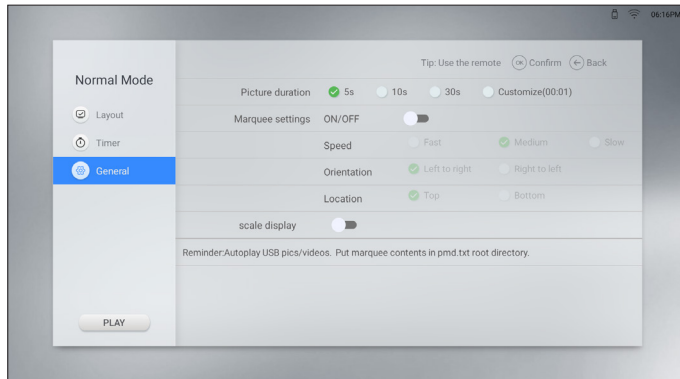

Normal Mode - General

"General" contains some basic settings, such as the playback time of pictures, marquee, whether video pictures are stretched, automatic switch machine and other settings.

- **Picture duration** : Set the image playback time
- 5s / 10s / 30s / Customize
- **Marquee settings** : Put the pmd.txt file with the marquee content into the root directory of the U disk, turn on the marquee switch, the marquee file will also playing when playing the resource.
 - **Speed** : Fast / Medium / Slow
 - **Orientation** : Left to right / Right to left
 - **Location** : Top / Bottom
- **Scale display** : Adaptive control switch, video and pictures played after opening will not be stretched

04_ Local Signage

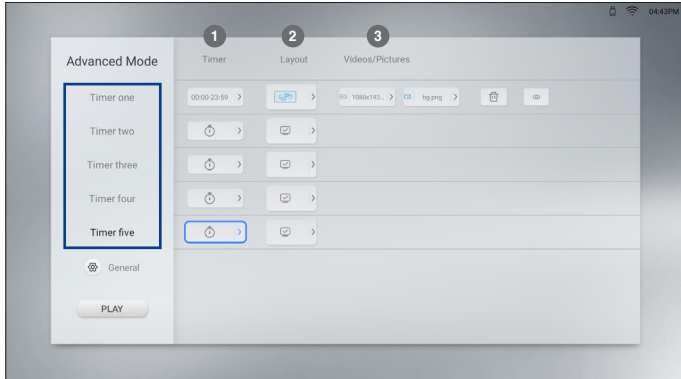

Advanced Mode - Timer

5 time periods can be set in Advanced Mode, and each time period can be customized to set the time (accurate to the minute), layout and playback content.

- **How to set time** : Options box under Timer → Press **OK** on the remote → Set time → Press the return key

Advanced Mode - Layout

The Layout of Advanced Mode is the same as the Layout of Normal Mode(Click to view), there are landscape and portrait screen options, and a total of 8 layouts

- **How to set Layout** : Options box under Layout → Press **OK** on the remote → Chose Layout → Press **OK** to confirm selection and return

Advanced Mode - Videos/Pictures

The Videos/Pictures in Advanced Mode are the media resources corresponding to the layout of the setting period. You need to insert a U disk to read the resources. The media resources are read from the U disk and classified by pictures and videos. After selecting the corresponding item in the resource list, it will bind the layout of the period.

- **How to chose resource** : Insert a U disk → Option box under Videos/Pictures → Press **OK** on the remote → View U disk resources, as → Press up, down and left keys to chose options → Press **OK** to confirm selection → Press the return key



Delete a single period of content



View a single period of content

PLAY

Play the content of the current period

04_ Local Signage

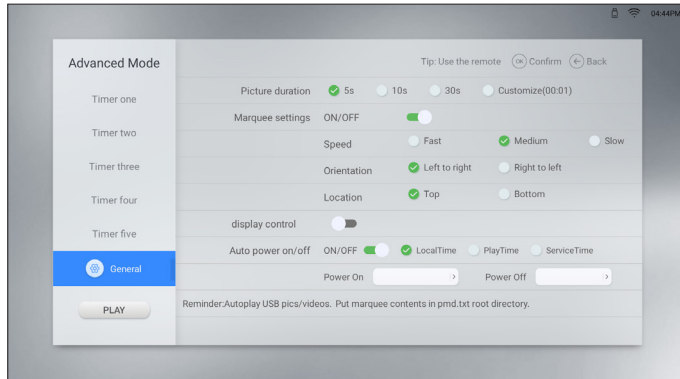

Advanced Mode - General

The general settings of Advanced Mode are the same as those in Normal Mode, including the picture duration setting, marquee setting, adaptive setting and automatic power-on/off setting functions.

- **Picture duration** : Set the image playback time
- 5s / 10s / 30s / Customize
- **Marquee settings** : Put the pmd.txt file with the marquee content into the root directory of the U disk, turn on the marquee switch, the marquee file will also play when playing the resource.
 - **Speed** : Fast / Medium / Slow
 - **Orientation** : Left to right / Right to left
 - **Location** : Top / Bottom
- **Scale display** : Adaptive control switch, video and pictures played after opening will not be stretched

05_ Fastcast

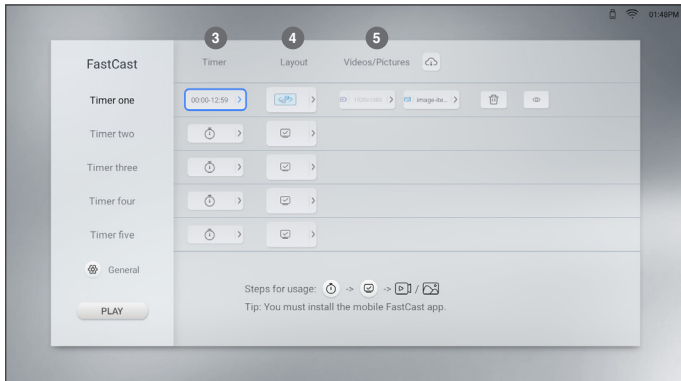
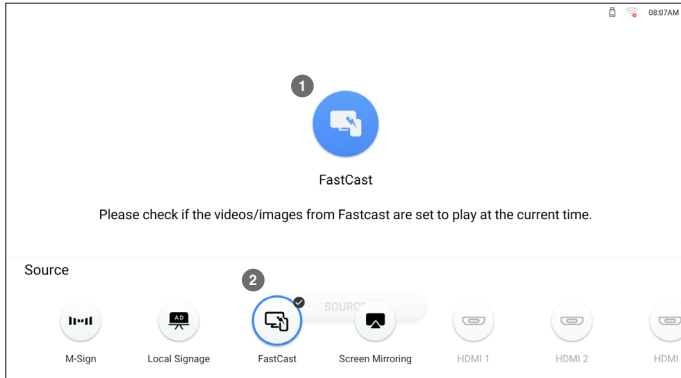

Ways to enter Fastcast :

1. Press **1** on Fastcast to enter
2. Press **2** on the remote and choose Fastcast **3** to enter.

Fastcast - Timer **3**, Layout **4** functions are consistent with Local Signage (click to view)

Fastcast--Videos/Pictures **5**

The resources of Videos/Pictures in Fastcast come from the mobile phone, the mobile phone and the application are connected through the network disk to obtain the resources in the mobile phone

• How to connect mobile phone network disk

1. Connect mobile phone and digital signage system to the same network;
2. Install the Fastcast app on your phone and open it;
3. Type in Videos/Pictures **5**, click [Fastcast], and select the corresponding mobile phone network disk;
4. Agree to the authorization of 'XX device access' on the mobile phone;
5. When the connection is complete, enter and select the resources in the mobile phone to download and play;



View downloading resources

PLAY

Play the content of the current period

05_ Fastcast

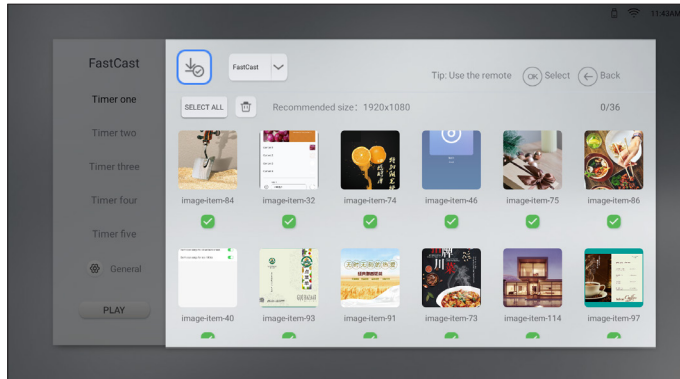

Explanation of some icons in Fastcast



List of downloaded mobile resources : Fastcst -> Videos/Pictures

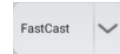

Mobile phone network disk connection entrance : Fastcst -> Videos/Pictures



Select network disk connection : Fastcst -> Videos/Pictures -> Fastcast

06_ Screen Mirroring

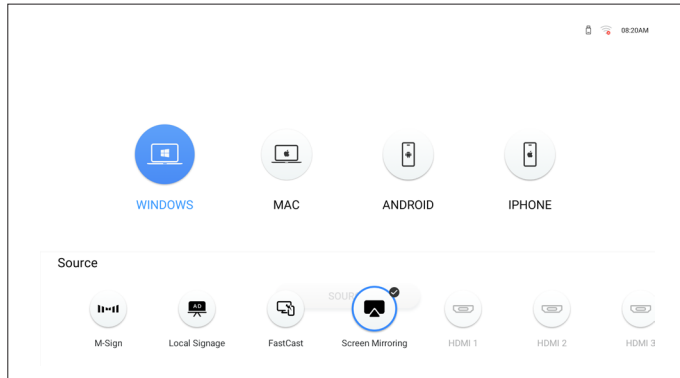

Screen Mirroring

Screen Mirroring, supported on four systems: Windows, Mac, Android, and iPhone, allowing the mirroring of screens from each system onto digital signage products.

07_ HDMI

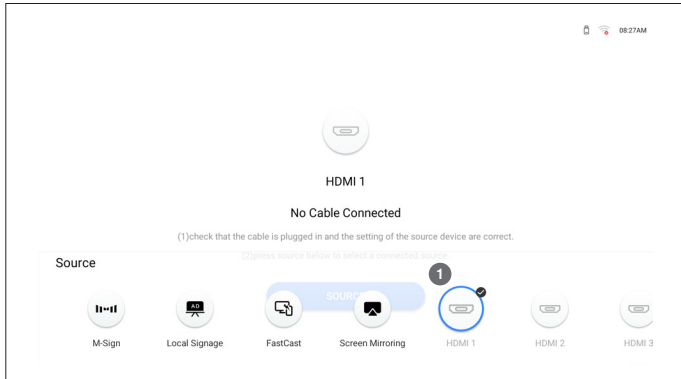

Explanation of HDMI

HDMI (High Definition Multimedia Interface) is a digital video/audio interface technology that meets the standards of the high-definition era and can be used in set-top boxes, DVD players, personal computers and televisions. HDMI can transmit audio and video signals at the same time, and can transmit uncompressed high-definition video and multi-channel audio data with high quality.

Way to connect HDMI

Connect the external input device (computer, DVD player, etc.) through HDMI, Then press the remote control button  to select the connected entrance (HDMI 1/HDMI2/HDMI3), and you can view the content of the connected device.

Reminder : The HDMI port connected to the external device signal source will be highlighted, as shown in , indicating that the HDMI3 port is connected to the HDMI signal source

08_ Settings - Picture

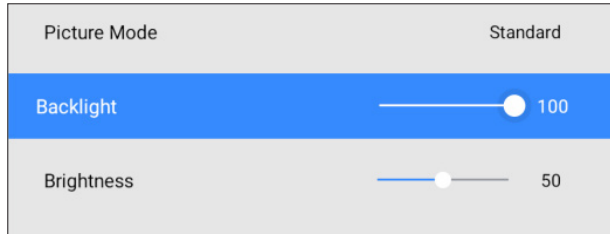
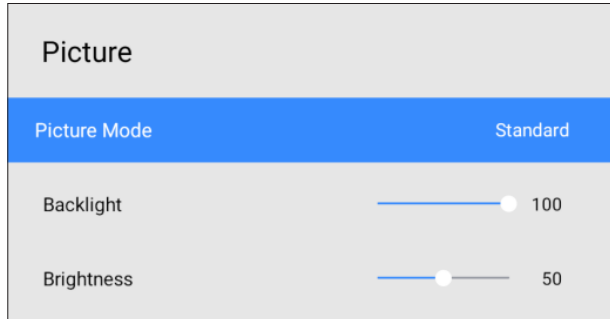

Picture Mode

 → Picture & Display → **Picture Mode**

Choose the best image quality option according to the usage scenario

- Standard
- Vivid
- Soft
- Sport
- Movie
- Monitor
- Game
- User

Backlight

 → Picture → **Backlight**

Adjust the brightness of the backlight to suit your preference

The maximum brightness value is 100

08_ Settings - Picture

Backlight		100
Brightness		50
Contrast		50

Brightness		50
Contrast		50
Sharpness		50

Contrast		50
Sharpness		50
Saturation		50

Brightness

→ Picture → **Brightness**

Improve overall image brightness by adjusting these levels.
When the value is close to 100, the brightness will increase.

Contrast

→ Picture → **Contrast**

Improve contrast by adjusting these levels.
As the value approaches 100, the contrast between light and dark colors increases.

Sharpness

→ Picture → **Sharpness**

Improve overall picture sharpness by adjusting these levels.
As the value approaches 100, the picture sharpness increases.

08_ Settings - Picture

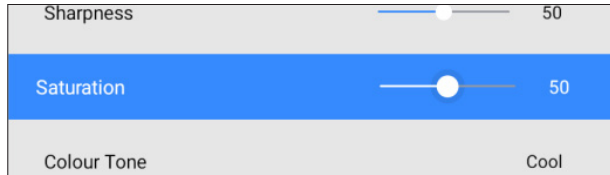

Saturation

⚙️ → Picture → **Saturation**

Improve overall picture saturation by adjusting these levels.

When the value is close to 100, the image saturation will increase

Colour Tone

⚙️ → Picture → **Colour Tone**

Choose the colour tone that best suits your viewing preferences

- Standard
- Warm
- Cool

08_ Settings - Picture

Colour Tone	Standard
Colour Control	
Play Settings	

Colour Control

 → Picture → **Colour Control**

Choose the RGB value that suits your visual preferences

- R : 0-255
- G : 0-255
- B : 0-255

08_ Settings - Picture

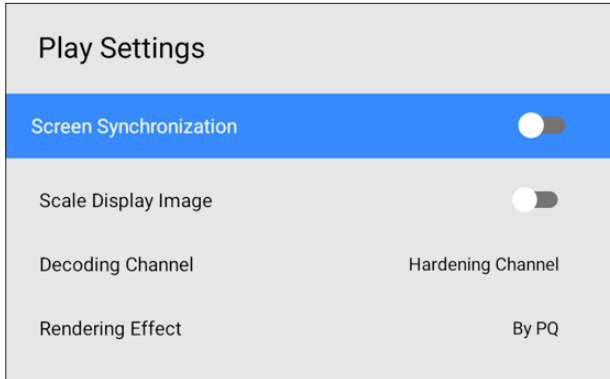

Play Settings

 → Picture → **Play Settings**

Change playback page related settings; This function can only be used before entering playback, once in playback, this function is hidden.

Play Settings → Screen Synchronization

 → Picture → **Play Settings** → **Screen Synchronization**

When machines connected to the same local area network and have this switch turned on, the screens will automatically synchronized.

Play Settings → Scale Display Image

 → Picture → **Play Settings** → **Scale Display Image**

When this feature is enabled, the image will not be stretched.

Play Settings → Decoding Channel

 → Picture → **Play Settings** → **Decoding Channel**

Decoding channels for image display during playback setup.

Play Settings → Rendering Effect

 → Picture → **Play Settings** → **Rendering Effect**

Rendering effect of the image during playback.

08_ Settings - On Screen Display

OnScreen Display	
Display Orientation	Landscape

Display Orientation	Landscape
Picture Size	16:9 Standard
Language	English

Picture Size	16:9 Standard
Language	English

Display Orientation

 → On Screen Display → Display Orientation

Select the screen content display orientation between landscape and portrait mode

- Landscape
- Protrait
- 180° Rotate

Picture Size

 → On Screen Display → **Picture Size**

Choose the picture size that best suits your viewing environment

- Auto
- 16:9 Standard
- 4:3

Language

 → On Screen Display → **Language**

Change language

- English / Deutsch / Italiano / Español / 中文(简体) / 中文(繁体) / العربية / 한국어 / Français / Português

08_ Settings - On Screen Display

HDMI Mode	HDMI 1.4
-----------	----------

Auto HDMI Switching	Off
---------------------	-----

Auto HDMI Switching	Off
Primary Source	HDMI 3

HDMI Mode

 → On Screen Display → **HDMI Mode**

Switch HDMI mode to support different resolutions, only valid when there is an HDMI signal input.

- HDMI1.4
- HDMI2.0

Auto HDMI Switching

 → On Screen Display → **Auto HDMI Switching**

Switch to a valid HDMI source when the main source device is disconnected.

- on
- off

Primary Source

 → On Screen Display → **Primary Source**

Set HDMI main input source. If there is no signal input under the current HDMI source, it will automatically switch to the pre-set HDMI main input source. This function is effective only when Auto HDMI Switching is set to off.

- HDMI1/HDMI2/HDMI3

08_ Settings - Sound

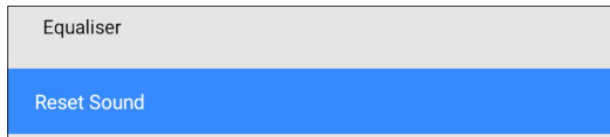
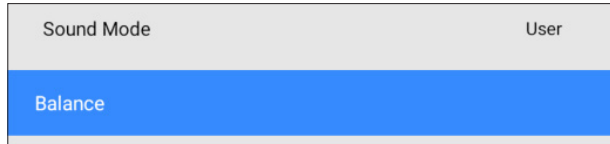
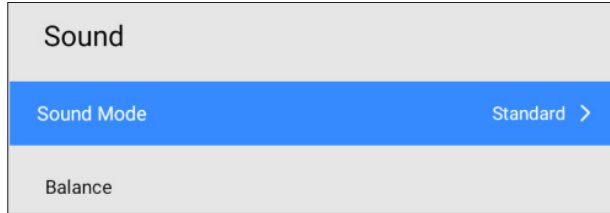

Sound Mode

 → Sound → **Sound Mode**

Choose the sound mode that best suits your audio environment

- Standard
- Music
- News
- Movie
- Game
- Customization

Balance

 → Sound → **Balance**

Adjust the speaker volume to optimize the balance of the background sound.

- Left / Right
- Reset

Equaliser

 → Sound → **Equaliser**

Adjust the equalizer to customize volume and tone, and enhance the richness of sound output. This feature is effective when the Sound Mode is set to User mode.

Reset Sound

 → Sound → **Reset Sound**

Restore all sound to default settings.

08_ Settings - Network

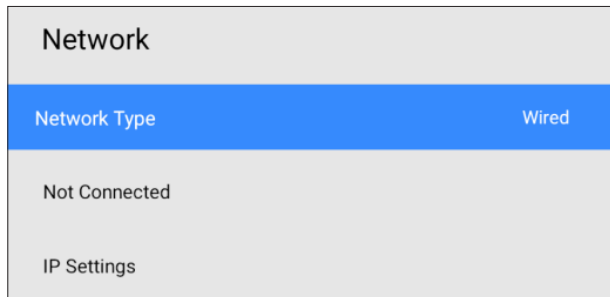
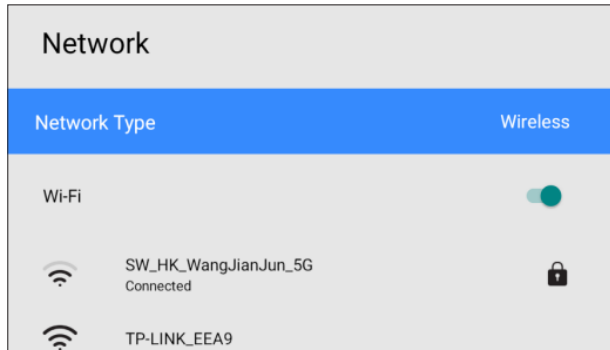

Network Type

⚙️ → Network → **Network Type**

- Wi-Fi / Ethernet

Wireless

Connect to a wireless network, click the connected network, you can see the connection status, IP address, MAC address, signal strength of the wireless network, and you can forget the network.

Wired

Select the wired network, you can see whether the wired network is connected, and you can modify the IP settings.

08_ Settings - System

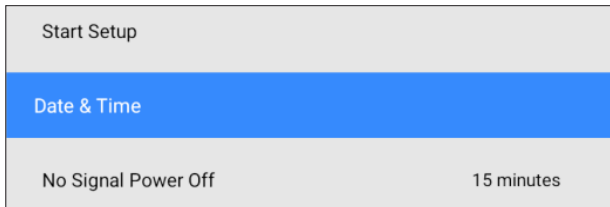
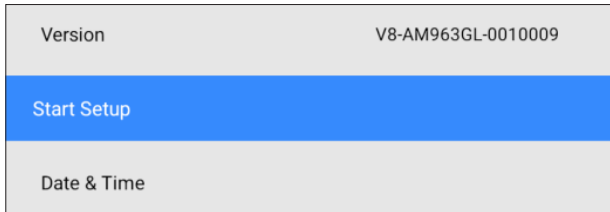
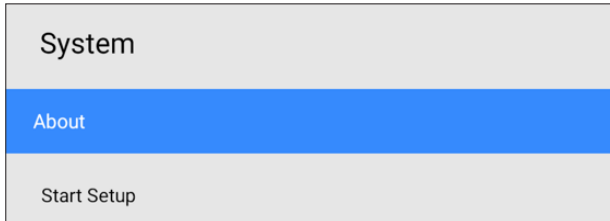

Version

 → System → About

Relevant configuration information about this device includes the system version number, device name, device ID, MAC address, available RAM, and storage memory.

Start Setup

 → System → **Start Setup**

Re-enter the Startup Wizard portal, which can be used to reset the initialization menu

- By the way, if you want to reinstall a third-party app as your CMS, you can follow these steps:
- **Start Setup → Step 5 of the boot wizard** : "Play via" → Custom CMS App → install your CMS application
→ Select the installed CMS as Play via → Done

Date & Time

 → System → **Date & Time**

Set the current date and time

- **Automatic date & time** : on / off
- **Date**
- **Time**
- **NTP Settings**
- **Use-hour format** : on /off

08_ Settings - System

Date & Time	
No Signal Power Off	15 minutes
Change PIN	

On/Off Timer

No Signal Power Off	15 minutes
Change PIN	

No Signal Power



→ System → **No Signal Power**

Turn off the device to save power when no signal is received from any program source.

- off / 15min / 30min / 45min / 60min

On/Off Timer



→ System → **On/Off Timer**

Used to set the device to power on or power off at a fixed time.

- Off
- **Standard** : You can set it manually or obtain the time set by the M-Sign messaging system as the timing power on and off time
- **PlayTime** : Gets the playback start time of the content played in the Local Signage or Fastcst feed as the timer power on and off time

Change PIN



→ System → **Change PIN**

Change the six-digit personal identification number (PIN)

08_ Settings - System

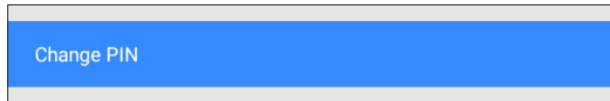
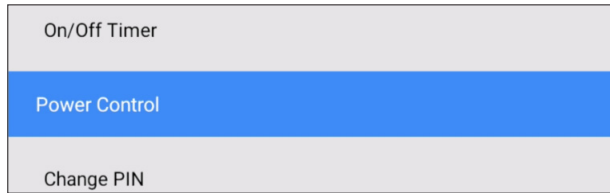

Power Control

 → System → **Power Control**

Configure various power-related options.

- **Auto Power On** : After turning it on, connect the power supply to turn on the system immediately, no need to use the remote control
- **HDMI Wake-up** : Let the device that has entered the hibernation state or shutdown state wake up from the hibernation state by connecting to HDMI, restore it to the working state, or switch from the shutdown state to the power on state
- **Wake On Lan** : Let the device that has entered the hibernation state or shutdown state issue instructions to it through the other end of the local area network (wired network) to wake up from the sleep state, resume the operating state, or transition from the shutdown state to the power on state.
- **Power Button** : Set the function of the power button on the remote control. You can set this button to turn the machine on only, or to turn the machine on and off

Change PIN

 → System → **Change PIN**

Change the six-digit personal identification number (PIN)

08_ Settings - System

No Signal Power Off	15 minutes	• Safety Lock On • Power On Button
Change PIN		• Button Lock • USB Auto Play Lock • Mobile Connection Lo...
Security		• HDMI Lock • Network Lock • USB Lock • Wired 802.1x Connect...
PC Connection Settings		• App Install Restriction...

Security

 → System → **Security**

- **Safety Lock on** : Turn on 'Safety Lock' to restrict all inputs, including inputs from remote control, panel buttons, keyboard, etc. Enter your PIN to disable this feature.
- **Power On Button** : This function allows the power button on the remote control to turn on the device even when the safety lock is activated.
- **Button Lock** : Used to change whether the button is enabled or disabled to adjust the functionality of the device.
- **Mobile Connection Lock** : Restrict other devices in the network (such as smartphones and tablets) from sharing content with your digital signage.
- **USB Auto Paly Lock** : Lock the autoplay function of USB devices to prevent automatic playback of content when connected to this product.
- **USB Lock** : Prohibited to connect to external USB ports.
- **HDMI Lock** : Restrict external devices connected to this product (such as computer monitors, laptop screens) from sharing content with your digital signage.
- **Wired 802.1x Connection** : Enable this option to connect to a wired 802.1x network.
- **Network Lock** : Block external network access.
- **App Install Restriction Lock** : Restrictions on Third-Party App Installation Permissions.

08_ Settings - System

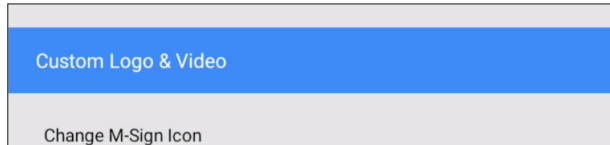
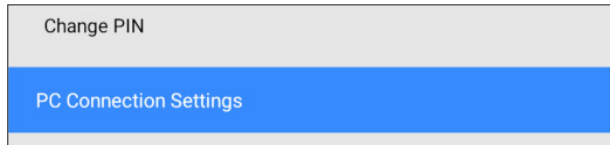

PC Connection Settings

 → System → **PC Connection Settings**

Choose the cable type to connect the monitor with the PC.

- PC Connection Cable : RS232C/RJ-45(LAN)Wi-Fi
- Port

Custom Logo & Video

 → System → **Custom Logo & Video**

Replace logo and power-on animation: (Reboot to take effect).

This operation requires storing resource files with specific specifications in the root directory of the connected USB device.

Logo format requirements : File name BootImage.bmp, 1080PBMP RGB_565 or RGB_888.

Boot animation format requirements : File name BootVideo.mp4,1080P,MP4

08_ Settings - System

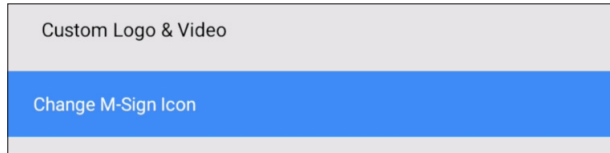

Change M-Sign Icon

 → System → **Change M-Sign Icon**

更换M-Sign的icon图标

Replace the icon for M-Sign

This operation requires storing resource files with specific specifications in the root directory of the connected USB device.

- **Icon requirements** : Prepare 2 files, one for the selected and one with the unchecked state
- **File name requirements** :
 - (1) Selected : cms_select.png,
 - (2) Unselected : cms_unselect.png,
- **Size format requirements** :
324 * 324, PNG

Reset

 → System → **Reset**

Newton SIGNAGE

EUROPE : support-signage@eu.solum-group.com / +49 6196 780 74 82

USA : dssupport@solu-m.com / +1-877-345-2830

JAPAN : sjc_info@solu-m.com / +81-(0)3-6273-3538

CENTRAL AND SOUTH AMERICA

MEXICO : sokmin.lee@solu-m.com / +52-5572110502

BRAZIL : paulomoratore@solu-m.com / + 55 11972451001

SOLUM